

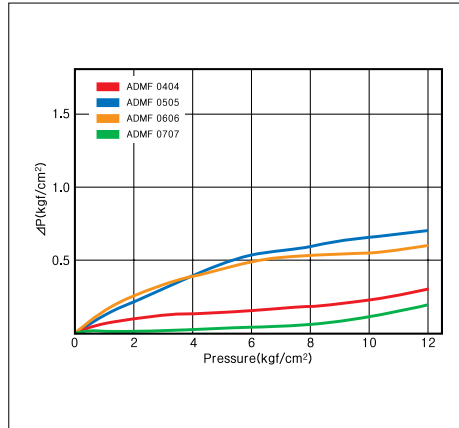

## ■ Features

- A rugged and durable filter strainer, available in 100 mesh (standard) 12 or with optional 150 or 200 mesh replaceable elements.
- **DMfit**. Compatible with DMfit tube and fittings, as well as standard-sized tubing from a variety of other manufacturers.
- Color options: gray, white, or black.
- The detachable CAP and BODY allow for easy servicing and cleaning.
- Can be used with a variety of chemicals and gases. However, when using with other than water or air, please refer to the Chemical Compatibility Tables or consult with your DMT representative.
- Do not apply excessive vibration, torque, shock or other strong loads to the filter. The filter body may be damaged or collets may be dislocated.

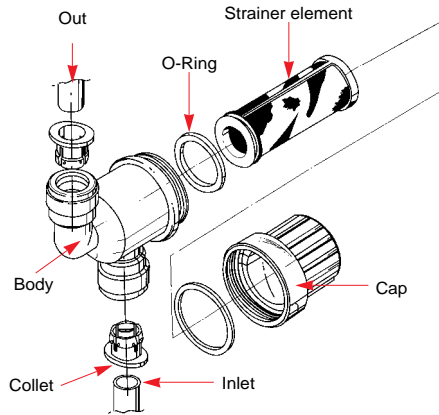

## ■ Maximum Operating Pressure / Temperature

Size	1/4"	5/16"	3/8"	1/2"
Parameter	6mm	8mm	10mm	12mm
Pressure	170psi			
Temperature	-20°F(-29°C) ~ +185°F(85°C)			

※ Maximum pressure values are based on use at room temperature.  
 ※ Consult your DMT representative when using at continuous elevated temperature and pressure

## ■ Inch Size (Standard-100Mesh)

PART NO.	INLET	OUTLET	Qty / Box
ADMF 0404	1/4	1/4	50
ADMF 0505	5/16	5/16	50
ADMF 0606	3/8	3/8	50
ADMF 0707	1/2	1/2	40

## ■ Filter Materials and Mesh Size

Screen Mesh	Standard	Special Order	
	100 Mesh	150 Mesh	200 Mesh
Materials	SUS		

※ Standard models are provided with 100 mesh screen elements.  
 ※ 150 and 200 meshes are available by special order.

## ■ Metric Size (Standard-100Mesh)

PART NO.	INLET (mm)	OUTLET (mm)	Qty / Box
ADMF 0606M	6	6	50
ADMF 0808M	8	8	50
ADMF 1010M	10	10	50
ADMF 1212M	12	12	40



DMT tubing is produced from an advanced grade of low density polyethylene. Its greatest advantage is superior environmental stress cracking resistance (ESCR), greatly exceeding that of ordinary polyethylene tubing as measured by ASTM D-1693 (IGEPAL) tests. Environmental stresses that can shorten the service life of tubing include chemical exposure, aging connections with barb-type fittings, or high vibration loads with connections to compression fittings. DMT tubing is compliant to ANSI/NSF-51, 61, SK, WRAS and FDA requirements for food contact applications. DMT tubing is available in multiple coding colors, and offers the user:

- Dimensional stability
- Uniformity and long-term strength
- Higher burst pressure
- Greater tensile strength
- Wide range of available colors.
- Suitable for use with **DMfit** products and those of other manufacturers.

## ■ Maximum Pressure and Temperature

Size	5/32"	3/16"	1/4"	5/16"	3/8"	1/2"
Parameter	4mm	5mm	6mm	8mm	10mm	12mm
Pressure	230 psi			170 psi		
Tube Tolerances	-0.1mm / +0.1mm					
Temperature	-20°F(-29°C) ~ +150°F(66°C)					

※ Pressure values are based on PE tube used at room temperature.  
 ※ Consult your DMT representative when using at continuous elevated temperature and pressure.

## ■ Colors Available

Suffix	Color	5/32"	3/16"	1/4"	5/16"	3/8"	1/2"	4mm	5mm	6mm	8mm	10mm	12mm
B	Blue	○	○	○	○	○	○	○	○	○	○	○	○
O	Orange	○	○	○	○	○	○	○	○	○	○	○	○
Y	Yellow	○	○	○	○	○	○	○	○	○	○	○	○
W	White	○	○	○	○	○	○	○	○	○	○	○	○
N	Natural	○	○	○	○	○	○	○	○	○	○	○	○
BK	Black	○	○	○	○	○	○	○	○	○	○	○	○
R	Red	○	○	○	○	○	○	○	○	○	○	○	○
Gr	Gray	○	○	○	○	○	○	○	○	○	○	○	○
G	Green	○	○	○	○	○	○	○	○	○	○	○	○

## ■ Order Information

### DPE 04 (M) - B - 0500

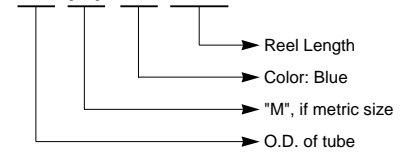

## TC - Tube Cutter

- **DMfit** Tube Cutter with quality blade is suitable for cutting plastic tubing sizes up to 13mm.



## ■ Inch Size

Part No.	O.D. In.	I.D. In.	Wall	Reel Length ft.
DPE 01	5/32"	0.094	0.031	1500
DPE 03	3/16"	0.125	0.031	1350
DPE 04	1/4"	0.170	0.04	1000
DPE 05	5/16"	0.216	0.048	650
DPE 06	3/8"	1/4"	0.062	500
DPE 07	1/2"	3/8"	0.062	300

## ■ Metric Size

Part No.	O.D. (mm)	I.D. (mm)	Wall (mm)	Reel Length (Meter)
DPE 04M	4	2.5	0.75	500
DPE 05M	5	3.5	0.75	400
DPE 06M	6	4	1	300
DPE 08M	8	6	1	200
DPE 10M	10	7	1.5	150
DPE 12M	12	9	1.5	100